

CI/SfB

(11.4) (52.5)

Common Arrangement R12

Uniclass

L13/L21/L52524/L141



# RoofCell

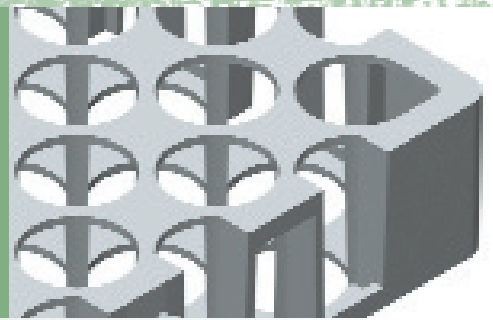

Sub surface drainage and  
water storage systems

# RoofCell

Sub soil drainage and water storage systems



**RoofCell is a lightweight, high strength, interlocking module that provides excellent sub-soil drainage and water storage for roof gardens, planters and landscaped decks.**

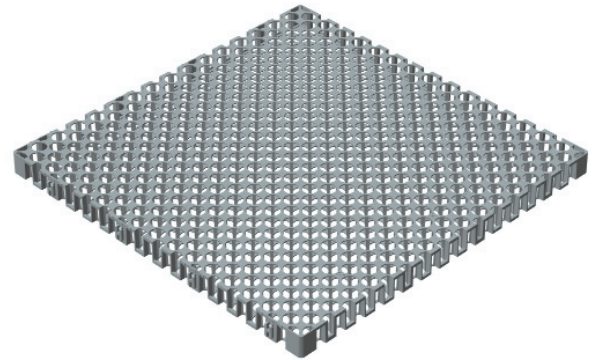

As well as improving the appearance of buildings, green roofs give architects and landscape gardeners many more benefits too.

By increasing insulation, green roofs can lower energy costs and improve the comfort of the internal environment. What's more they can improve air quality by reducing carbon monoxide, increasing oxygen supply and reducing the thermal drafts that draw up pollutants from surrounding areas.

Other benefits include reducing storm water run-off and increasing the life of waterproofing membranes by providing protection from UV, thermal shock and puncture.

As nominated distributors for RoofCell Drainage System and RoofCell Water Storage System, Stormwater Management Ltd is committed to high stock levels and exceptional customer service to help you improve the performance of your green roof projects.

## Applications:

- Roof gardens and landscaped decks
- Paved areas and roadways
- Sports fields and golf courses
- Retaining walls
- Bridge abutments, tunnels and landfills



# Product range



Singapore - Punggol East Public Housing Project, multistorey car park and roof garden



USA - Stamford University Medical Centre, landscape deck.



UK - Ascot Race Course (STRI) moveable track way / bridge.

**Lightweight and easy to join, RoofCell is quick to install with minimal on-site disruption and gives you the following benefits:**

- Rapid capture and discharge of surplus water
- High water storage capacity
- Effective return of stored water to planting via geotextile wicks
- Allows greater soil depths for a wider variety of plants
- Able to withstand pedestrian and light vehicle traffic

## Environmentally friendly

RoofCell is manufactured from 100% recycled plastics. It is inert to ground chemicals and bacteria and will not deteriorate from water absorption even during prolonged immersion.

## Long-term protection

As well as being compatible with all types of waterproofing membrane RoofCell protects the membrane from damage and deterioration.

## Efficiency

High surface and internal void volume results in efficient, high capacity drainage.

## Flexibility

RoofCell offers greater design flexibility as modules may be interlocked in one plane or at right angles to adjacent units to form continuous large panels and conduits.

**Please call 01455  
502222**  
or email [sales@storm-water.co.uk](mailto:sales@storm-water.co.uk)  
for further information.

Wide  
product  
range

Large  
stock  
holding

Next day  
delivery

# RoofCell Drainage System

RoofCell is a highly effective drainage system that rapidly captures and transports water - even under torrential conditions.

Installed directly onto the waterproofing membrane, RoofCell is then covered with a geotextile filter fabric before adding soil and planting. The compact modules give greater soil depth than other methods, letting you choose from a wider variety of plants for landscaping.

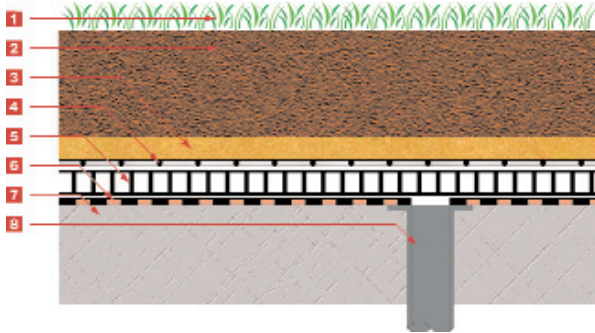

The RoofCell drainage system comprises:

- 1 Turf, ground cover and plants
- 2 Planting soil
- 3 Coarse washed sand ( if required)
- 4 Geotextile filter fabric
- 5 RoofCell modules
- 6 Waterproofing membrane
- 7 Roof deck
- 8 Drain outlet

# RoofCell Water Storage System

By positioning drainage outlets above the height of the RoofCell, it can also be used as an extremely efficient storage system by retaining water in its cellular structure. This stored water is returned to the soil by capillary wicks installed between the RoofCell modules.

In the event of flooding RoofCell's open structure and interlocked modules eliminate the possibility of flotation or movement for a robust, long-lasting solution for roof water storage.

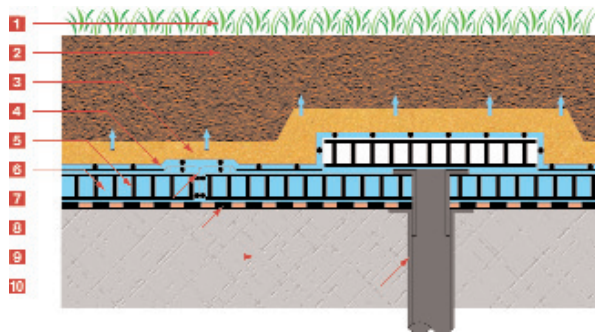

The RoofCell water storage system comprises:

- 1 Turf, ground cover and plants
- 2 Planting soil
- 3 Coarse washed sand ( if required)
- 4 Geotextile filter fabric
- 5 RoofCell modules
- 6 Stored Water
- 7 Geotextile capillary wick
- 8 Waterproofing membrane
- 9 Roof deck
- 10 Drain outlet

Design  
service

Onsite  
support

See all products  
online at  
[Storm-water.co.uk](http://Storm-water.co.uk)

stormwater  
**MANAGEMENT**

# RoofCell drainage applications

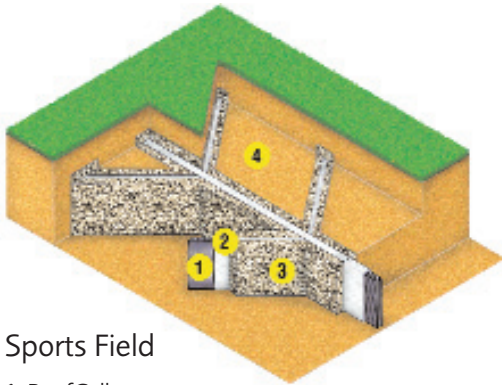

Sports Field

1. RoofCell
2. Geotextile
3. Course Sand
4. Soil

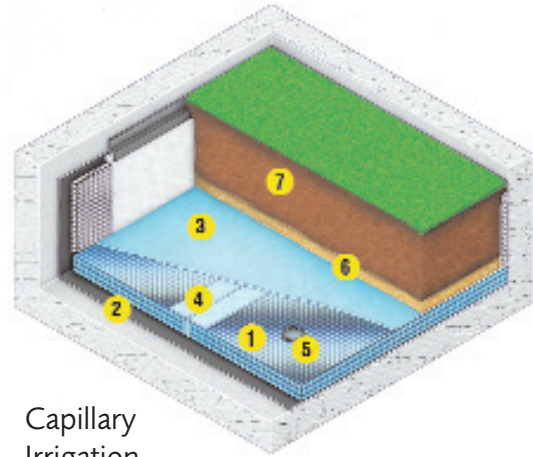

Capillary Irrigation

1. RoofCell
2. Waterproof membrane
3. Geotextile
4. Moisture wick
5. Overflow pipe
6. Coarse sand
7. Planting soil

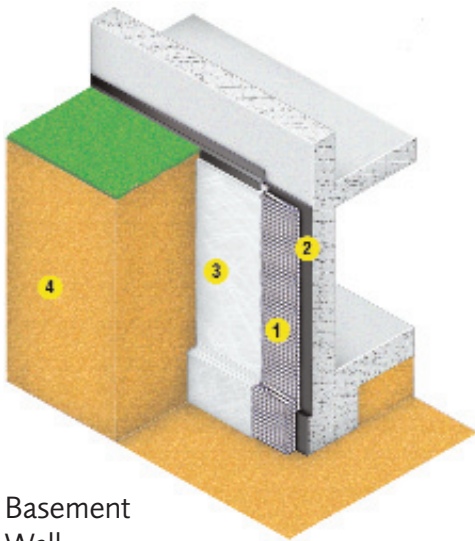

Basement Wall

1. RoofCell
2. Waterproof membrane
3. Geotextile
4. Soil

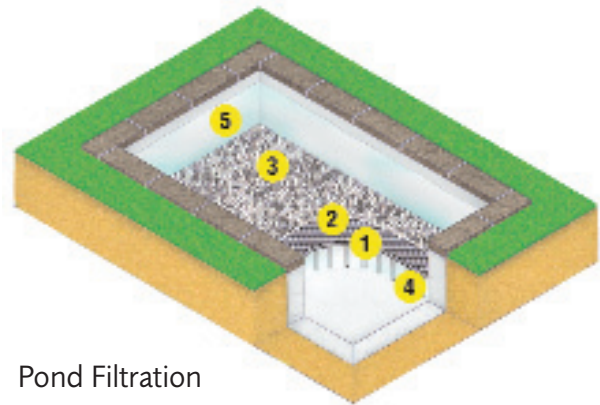

Pond Filtration

1. RoofCell
2. Geomesh
3. Pebbles
4. Pipe support
5. Waterproof membrane

**Stormwater Management Ltd is committed to offering the best solutions for soil stabilisation, erosion control, drainage and environmental protection problems.**

Well trained staff are always available to discuss which materials are best suited to any particular application.

# Technical specification

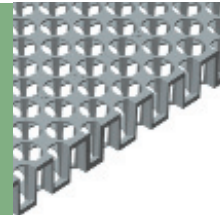

Size:	500 x 500mm
Height:	30mm
Weight:	3kg/m <sup>2</sup>
Material:	re-cycled polypropylene (100%)
Colour:	Black
Horizontal void area:	at least 58% in a circular design
Service temperature:	-30oc + 120oc
Compressive strength:	> 1,400 kN/m <sup>2</sup> /140 tonnes m <sup>2</sup>
Discharge capacity:	5.75 litres/sec @ 1% hydraulic gradient
Product Reference:	DM30H

This brochure is produced to give an example of the products we supply and how, subject to your own testing, our products may be used. Nothing in this brochure shall be construed so as to make any ascertain or give any warranty as to the fitness for purpose of any of our products in respect of any specific job. You should satisfy yourself through your own testing as to the suitability of our products for any specific purpose and rely solely on such testing and/or the advice of any professional(s) you commission. While we ensure as far as is possible that all information given in this brochure is accurate at the time of print, information and examples given in this brochure are by way of illustration only and nothing contained in this or any other promotional literature produced by us shall in any way constitute an offer or contract with you or shall be relied upon by you as a statement or representation of fact.

Please call - **01455 502 222**

or email [sales@storm-water.co.uk](mailto:sales@storm-water.co.uk) for more technical advice

and further information.

## Stormwater Management Ltd

Fleming Road, Harrowbrook Industrial Estate

Hinckley, Leicestershire LE10 3DU.

Fax: 01455 502 223

Email: [sales@storm-water.co.uk](mailto:sales@storm-water.co.uk)

